

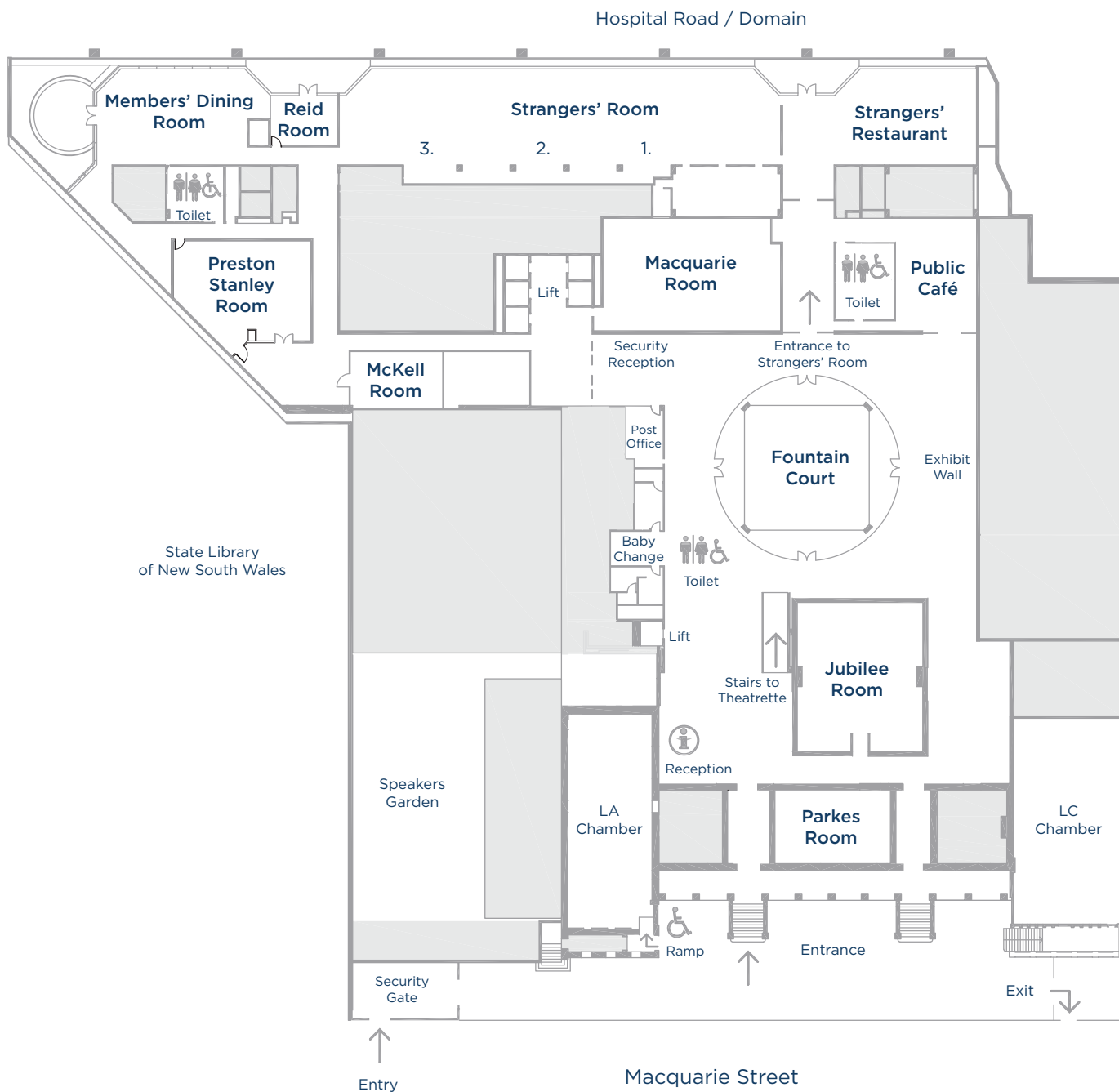

NSW PARLIAMENT FLOOR PLAN



CAPACITIES & HOURLY ROOM HIRE RATES

Name of Room	Capacity	Banquet Lunch or Dinner	Monday - Friday 8am - 5.30pm	After Hours Weekends
McKell Room	Boardroom 20 Cocktail 35	U-shape 18		
Reid Room	Boardroom 16 Cocktail 35	U-shape 14	\$150	\$700
Parkes Room	Boardroom 10	Cocktail 20		
Theatrette	Theatre 164	Cocktail 164		
Preston Stanley Room	Boardroom 42 Cocktail 80	U-shape 27 Theatre 80	Banquet 60 Cabaret 42	
Jubilee Room	Boardroom 18 Cocktail 90	U-shape 18 Theatre 80	Banquet 50 Cabaret 40	\$200
Members' Dining Room	Boardroom 28 Cocktail 100 Banquet 48	U-shape 24 Theatre 60 Cabaret 32	Banquet 60 Cabaret 40	
Strangers' Room	Banquet 180 Cocktail 600	Cabaret 126 Theatre 384	Banquet 300 Cabaret 210	\$400
Fountain Court	Cocktail 200			
Strangers' Room + Fountain Court	Cocktail 800	Theatre 384	\$400	\$800

Room hire is charged per hour.

Minimum of two hour hire applies for weekdays.

Minimum of four hour hire applies for weekends.

Setup access on request.

Room hire begins from when the first person accesses the building to when the last person vacates.

Room hire is inclusive of security provided by NSW Special Constables.

Minimum numbers and minimum spends may apply.

10% surcharge applies on the total spend for Saturday and 15% on a Sunday.

Refer to the terms and conditions of the venue hire.



Banquet
round tables
with chairs



Cabaret
round tables
with chairs



Boardroom
one long table



Cocktail
standup



U-shape
U board
table



Theatre
chairs only

*The Fountain Court is on a request basis and requires the approval of both Presiding Officers.